

Ex db eb CONTROL STATIONS AND Ex eb IIC TERMINAL BOXES



CONTROL STATIONS

TERMINAL BOXES

The terminal boxes contain Ex e and/or Ex i terminals for incoming/outgoing cable connections.

The control and signalling units series CE2K-... ..-CS-SSX can be equipped with certified components.

Terminal boxes and control station can be made in Stainless Steel and in GRP (Glass reinforced polyester).

Combustion and Energy certificate number:

ATEX CEC 15ATEX211 (ATEX), **RU C-ITA.AA87.B.00582** (Tr Cu), **LEC 16.0056** for Control Stations (INMETRO) and **LEC 16.0059** for Terminal Boxes (INMETRO).

GRP CONTROL STATIONS TECHNICAL SPECIFICATIONS



DESCRIPTION

The CE2K-...-CS-GRP range includes 25 sizes of enclosures manufactured in GRP (glass reinforced polyester) with 4mm thickness, that can be threaded.

Polyester is a valid alternative to aluminum, stainless steel or cast iron; it has excellent mechanical strength and a long life expectancy.

The terminal boxes series CE2K-...-CS-GRP are able to operate in an ambient temperature from -60°C to +85°C and consist of enclosures having degree of protection IP66 (with red or white colour silicone gasket placed on internal part of the lid) or IP66/67 (as option).

The control and signalling units series CE2K-...-CS-GRP can be equipped with certified components like:

- ammeter/voltmeter;
- switch module (for push-button, selector switch, control switch, etc.) and relevant actuator;
- safety switch;
- signalling lamp or Led; illuminated button;
- fuse;
- potentiometer.

Temperature class depends on the temperature class of the "hottest" component(s): if at least one component having temperature class T5 or T4 is mounted, the temperature class shall be T5 or T4.

The maximum permissible ambient temperature of the certified operators shall duly be considered.

For area of drilling on the lid must be considered the lid dimensions less 15%.

GRP CONTROL STATIONS TECHNICAL SPECIFICATIONS

KEY FEATURES

| | |
|----------------------------|--|
| Material of enclosure: | Black glass fibre reinforced polyester resin graphite added (surface resistance <math><1\text{G}\Omega</math>) |
| Thickness: | 4mm |
| Degree of protection: | IP66 (IP66/67 as option) |
| Back fixing points | |
| Gasket: | silicone |
| Mounting plate | as option |
| Mounting plate dimensions: | see technical details |
| Cover: | solid |
| Cover fixing: | by screws |

ELECTRICAL FEATURES

| | |
|------------------------------|----------------|
| Max. rated voltage (Ex e): | 11k VAC or VDC |
| Max. rated voltage (Ex i): | 30 VAC or VDC |
| Frequency: | 50/60 Hz |
| Maximum rated current: | 520A |
| Maximum rated cross section: | 300sqmm |

CERTIFICATES

| | |
|----------------------|--|
| Certificates Number: |  CEC 15ATEX211 |
| |  RU C-IT.AA87.B.00582 |
| |  LEC 16.0056 |

Address

COMBUSTION AND ENERGY SRL
Via per Dolzago, 21 - 23848 - Oggiono - LC - Italy

Web

www.ce2k.com - info@ce2k.com

Contacts

Ph: +39 0341.260926 - Fax: +39 0341.577747

GRP CONTROL STATIONS - DIMENSIONS

| Model | External dimensions | | | Internal dimensions | | | Fixing | | Screw |
|----------------------|---------------------|-----|-----|---------------------|-----|-----|--------|-----|-------|
| | H | W | D | h | w | d | H+ | W+ | |
| | mm | mm | mm | mm | mm | mm | | | |
| CE2K-12 12 09-CS-GRP | 120 | 122 | 90 | 102 | 104 | 80 | 82 | 106 | M6 |
| CE2K-12 22 09-CS-GRP | 120 | 220 | 90 | 102 | 190 | 80 | 82 | 204 | |
| CE2K-16 16 09-CS-GRP | 160 | 160 | 90 | 142 | 112 | 80 | 110 | 140 | |
| CE2K-16 26 09-CS-GRP | 160 | 260 | 90 | 142 | 212 | 80 | 110 | 240 | |
| CE2K-16 36 09-CS-GRP | 160 | 360 | 90 | 142 | 312 | 80 | 110 | 340 | |
| CE2K-16 56 09-CS-GRP | 160 | 560 | 90 | 142 | 512 | 80 | 110 | 540 | |
| CE2K-20 25 12-CS-GRP | 200 | 250 | 120 | 180 | 230 | 110 | | | |
| CE2K-25 25 12-CS-GRP | 250 | 255 | 120 | 230 | 235 | 110 | 200 | 235 | |
| CE2K-25 25 16-CS-GRP | 250 | 255 | 160 | 230 | 235 | 140 | | | |
| CE2K-25 40 12-CS-GRP | 250 | 400 | 120 | 230 | 380 | 110 | 200 | 380 | |
| CE2K-25 40 16-CS-GRP | 250 | 400 | 160 | 230 | 380 | 160 | | | |
| CE2K-25 60 12-CS-GRP | 250 | 600 | 120 | 230 | 580 | 110 | | | |
| CE2K-25 60 16-CS-GRP | 250 | 600 | 160 | 230 | 580 | 140 | | | |
| CE2K-40 40 12-CS-GRP | 405 | 600 | 120 | 385 | 580 | 110 | | | |
| CE2K-40 40 16-CS-GRP | 405 | 400 | 165 | 385 | 380 | 154 | 355 | 380 | |

Dimensions and weights are approximate and subject to change without notice.

Address

COMBUSTION AND ENERGY SRL
Via per Dolzago, 21 - 23848 - Oggiono - LC - Italy

Web

www.ce2k.com - info@ce2k.com

Contacts

Ph: +39 0341.260926 - Fax: +39 0341.577747

GRP CONTROL STATIONS - DRAWINGS

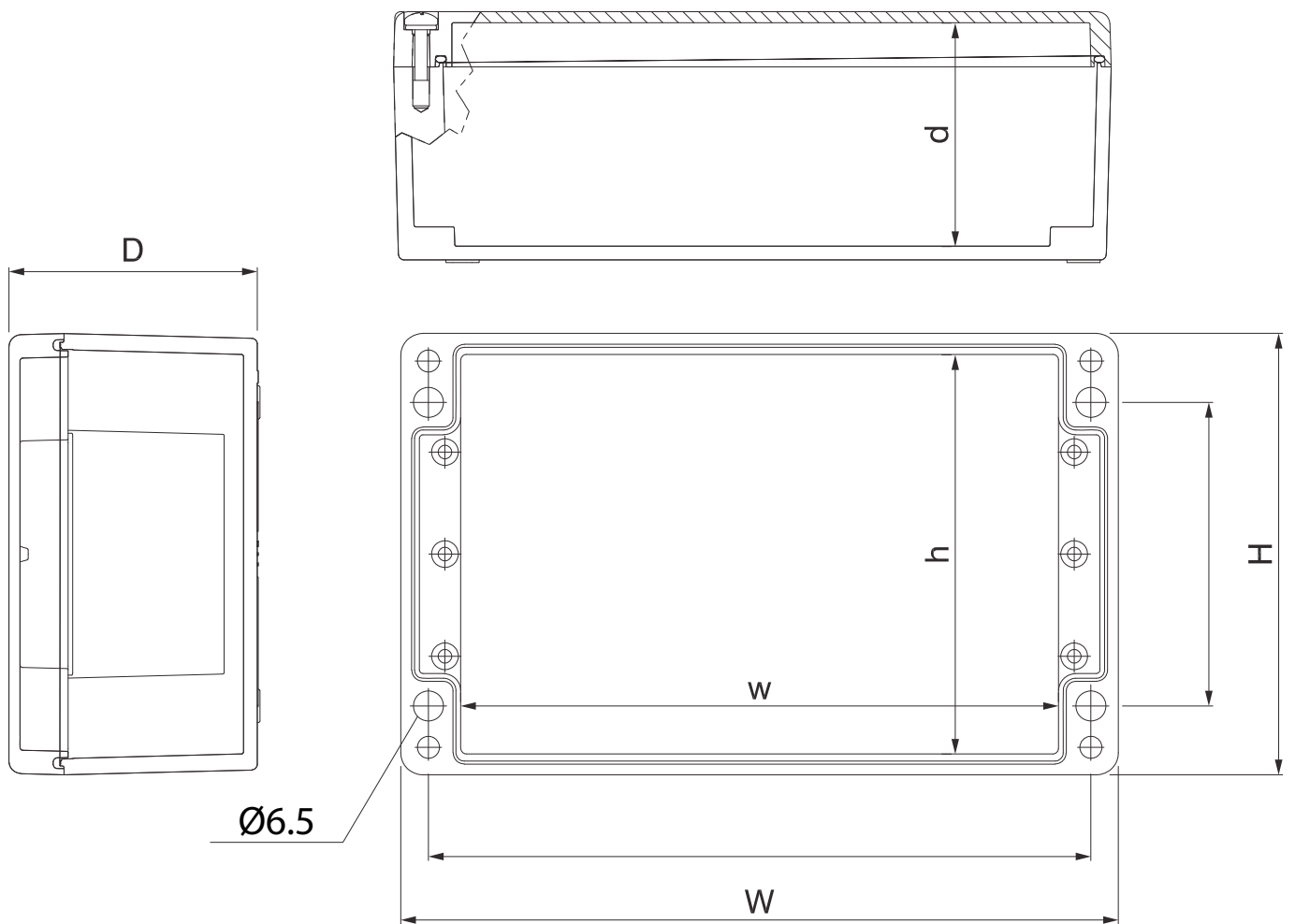

Address

COMBUSTION AND ENERGY SRL
Via per Dolzago, 21 - 23848 - Oggiono - LC - Italy

Web

www.ce2k.com - info@ce2k.com

Contacts

Ph: +39 0341.260926 - Fax: +39 0341.577747